

- KEY
- 01 HOTEL MAIN LIFT LOBBY
 - 02 HOTEL SERVICE LIFT LOBBY
 - 03 HOTEL BOH
 - 04 SERVICED APARTMENT MAIN LIFT LOBBY
 - 05 SERVICED APARTMENT SERVICE LIFT LOBBY
 - 06 RESIDENTIAL LIFT LOBBY
 - 07 LINEN STORE
 - 08 CLEANER'S CUPBOARD
 - 09 STORAGE
 - 10 IT CABINET

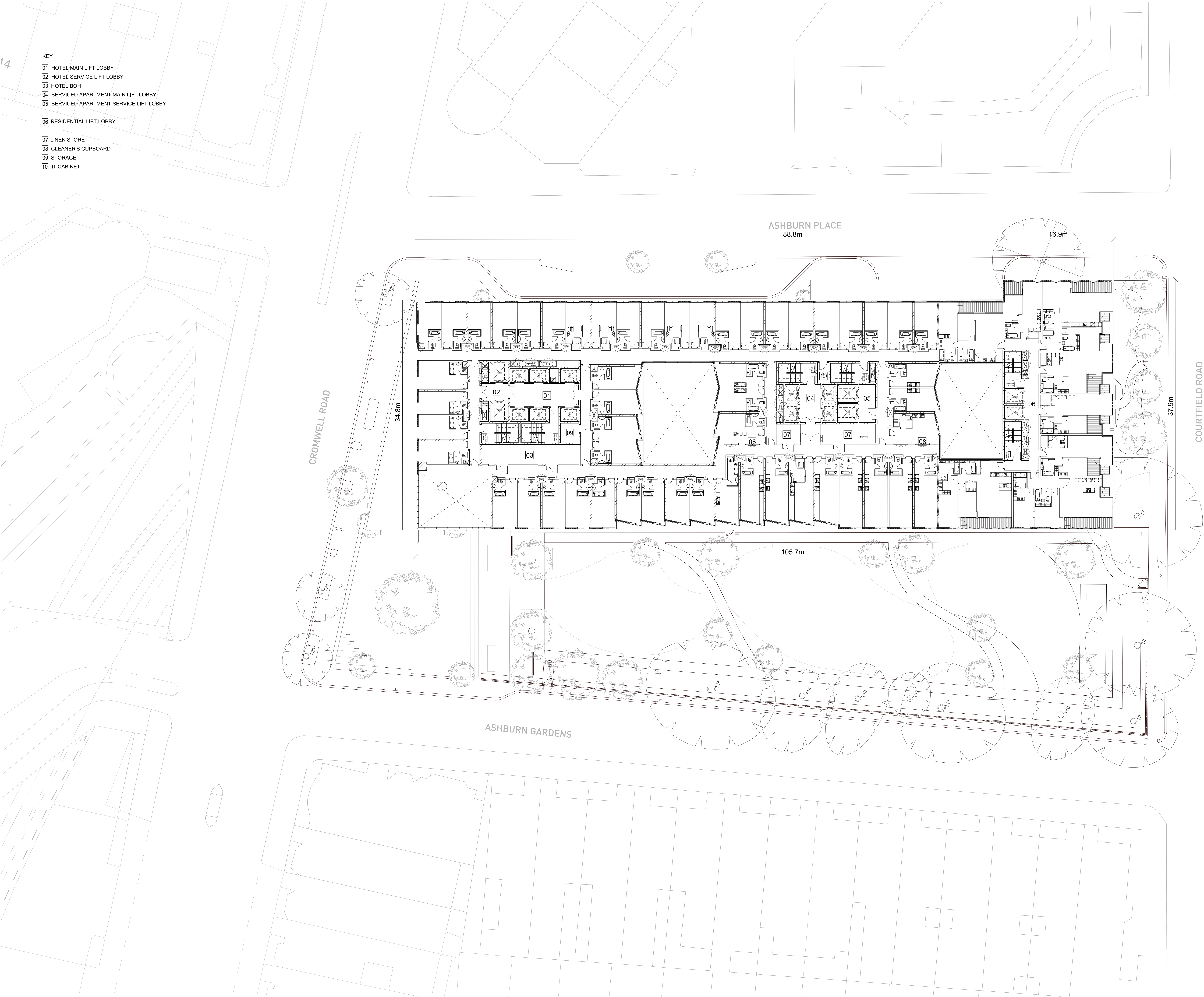

This drawing is copyright.
Do not scale off dimensions.
All dimensions to be checked on site by contractor.
Contractor to report any dimensional discrepancies,
errors or omissions prior to commencing on site.

NOTE:

NORTH

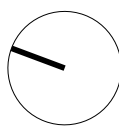

Rev	Date	Description	Rev	Date	Description
-	15/06/2019	Full Planning Application			
A	11/01/2019	GLA Callin Amendments			

Project Title
Kensington Forum Hotel
Kensington, London

Status
PLANNING

Drawing Title
Level 06 Floor Plan

Job No 10106	Scale 1:200(A0) NTS(A3)	Date JAN 2019
Drawing No 10106-A-DRG-ZZ-G200-2006-PL	Revision A	

simpsonhaugh

MANCHESTER
Riverside, 4 Commercial St
M4 6DY 0161 835 2400
www.simpsonhaugh.com

LONDON
2nd Roberts Place
LONDON EC1A 9BB
020 7593 9800
mail@simpsonhaugh.com